

CITY COUNCIL
COMMITTEE ON ZONING, LANDMARKS AND BUILDING STANDARDS

COUNCIL ORDER

RE: Approval of sign over 100 square feet in area or over 24 feet above grade

ORDERED, that the City Council hereby approves the following sign application submitted by:

Applicant*: Citgo Petroleum

(* The Applicant is the owner of the real property or the business tenant of the real property. Do not list the sign contractor, sign erector, sign company or advertising entity in the above space.)

This Order approves the following sign in accordance with Municipal Code of Chicago Section 13-20-680:

Address of Sign: 7601 S State St Chicago, IL 60619

Zoning District: M1-2

DOB Sign Permit Application #: 101033270

Sign Details:

1. On-premise OR Off-premise
2. Static sign OR Dynamic-image display sign
3. Number of sign faces 2
4. Projecting over the public way No (Yes or No) If yes, Public Way Use #: _____
5. Dimensions: Length 12 feet 0 inches Height 12 feet 0 inches
Total square feet in area: 144
6. Height above grade: 86 feet 0 inches **To top of sign or sign structure**
7. Elevation (side of building or lot where the sign will be erected): West
8. Name of Sign Contractor/Erector: Jas. D. Ahern Company

To be legal, such sign shall comply with all provisions of Title 17 of the Chicago Municipal Code ("Zoning Ordinance") and all other provisions of the Municipal Code governing the permitting, construction and maintenance and removal of signs and sign structures. Failure of the applicant and the applicant's successors to comply shall be grounds for invalidation or revocation of the sign permit.

Alderman

6
Ward

NOTE: CABINET TO BE LED ILLUMINATED



ILLUMINATION VIEW



OPPOSITE VIEW

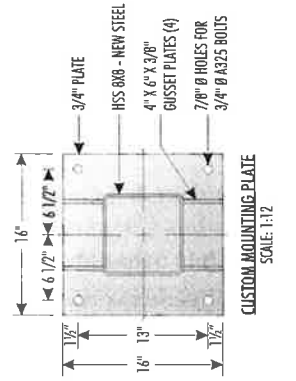

FRONT VIEW

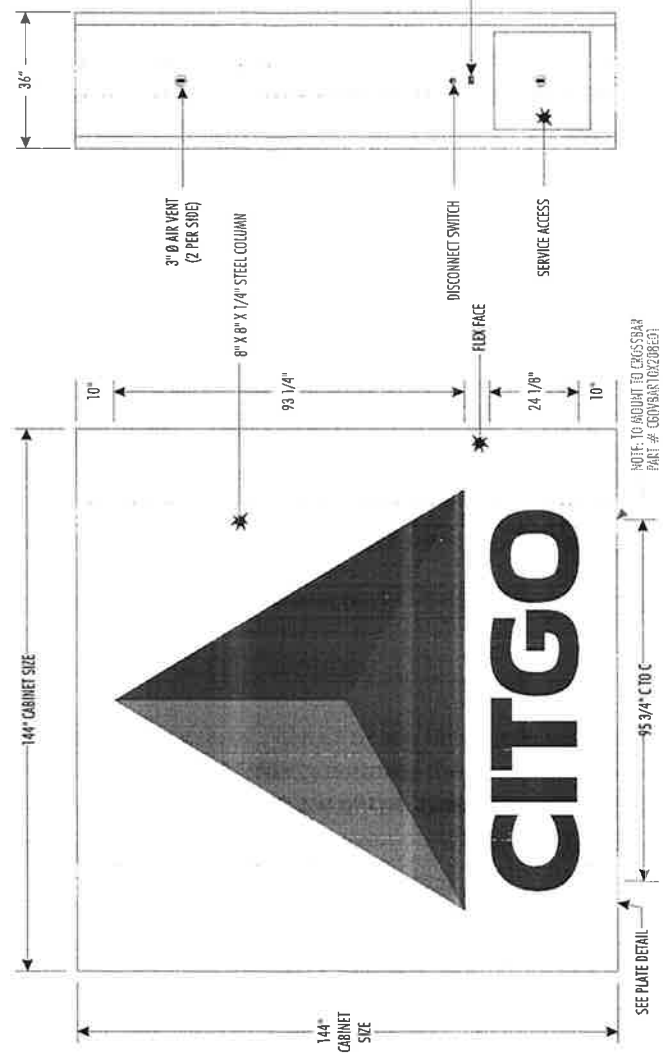

TOP VIEW

SIDE VIEW



REVISION HISTORY:

NO.	DATE	BY	DESCRIPTION
1	07/18/23	E.S.	INITIAL DRAWING RELEASE
2	07/27/23	E.S.	ADDED CUSTOM MOUNTING PLATE
3	07/27/23	E.S.	UPDATE TO SLOTTED MOUNTING HOLES
4	04/18/23	E.S.	UPDATE MOUNTING HOLES
5	05/23/23	K.A./J.S.	ADDED UL STICKER

PARTS LIST:

ITEM	DESCRIPTION
A	760518 - TOP/BACK COVER
B	760519 - BOTTOM REINFORCEMENT
C	760520 - STRUCTURE BRACKET
D	760521 - HOLE BRACKET
E	760522 - AIR VENT
F	760523 - CONNECTOR BRACKET
G	760524 - AIR VENT BRACKET

FIRST SURFACE DECORATION
SCALE: 3/8" = 1"

THIS SIGN IS INTENDED TO BE INSTALLED IN ACCORDANCE WITH THE REQUIREMENTS OF THE PERMITTING AGENCY AND ANY OTHER APPLICABLE LOCAL CODES. THIS INCLUDES PROPER DRUMMING AND DRUMMING FREQUENCY.

GENERAL NOTES

1. DIMENSIONS (UNLESS NOTED)
2. CABINET - 1/2" OVERLAP - 1/16" OVERLAP
3. ALL COPY LEVEL UNLESS NOTED OTHERWISE
4. WIRING DISTANCE 2" TO 5" UNLESS NOTED OTHERWISE
5. FINISH COLOR INDICATES USE OF STANDARD PAINT SYSTEM
6. ALL ELECTRICAL WORK TO COMPLY WITH UL 60

CITGO ID 12' X 12'
ILLUMINATED DOUBLE FACE
TWIN POLE HI RISE SIGN

7601 S. STATE ST
 7601 S. STATE ST
 48061
 08/18/22
 E 1 OF 2
 CG07P144X144601

APPROVAL SIGNATURE _____ **DATE** _____
 By signing, you are validating the dimensions and graphic provided to SignResource and/or you are handling your own installation.

Please Note: Weights and Measures requirements vary by State, County and Municipality. It is the responsibility of the customer to confirm that these graphics are compliant with all local Regulations, Statutes and Ordinances. Compliance must be confirmed by the party obtaining the permit. SignResource is not liable for misinterpretation of local Weights and Measures requirements or any rule changes that may occur after the order has been placed. If permitting and installation is provided by SignResource, we will make every effort to confirm the signage provided is compliant at the time of installation.

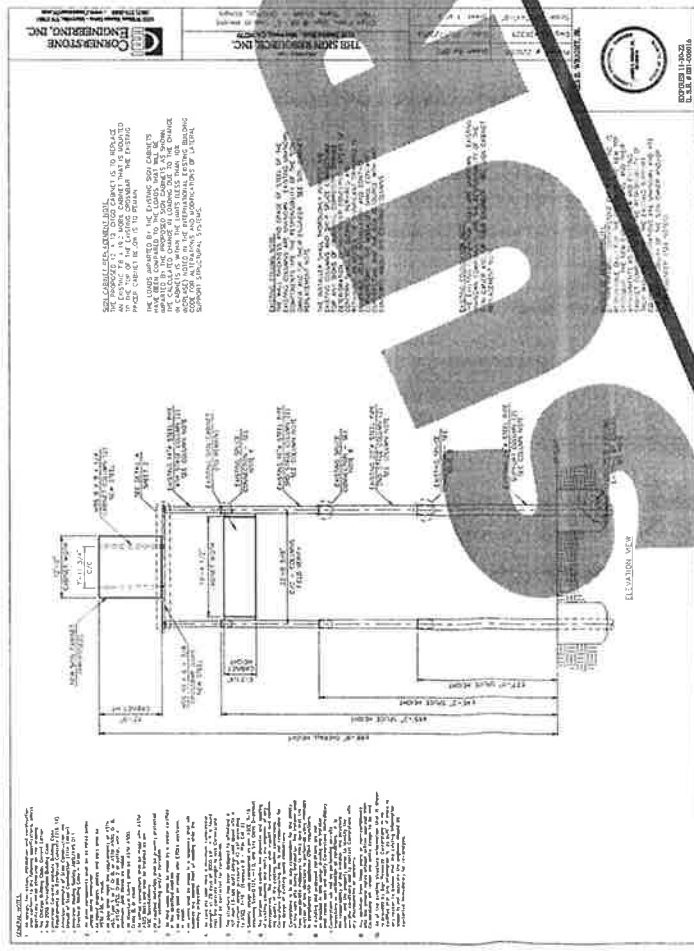
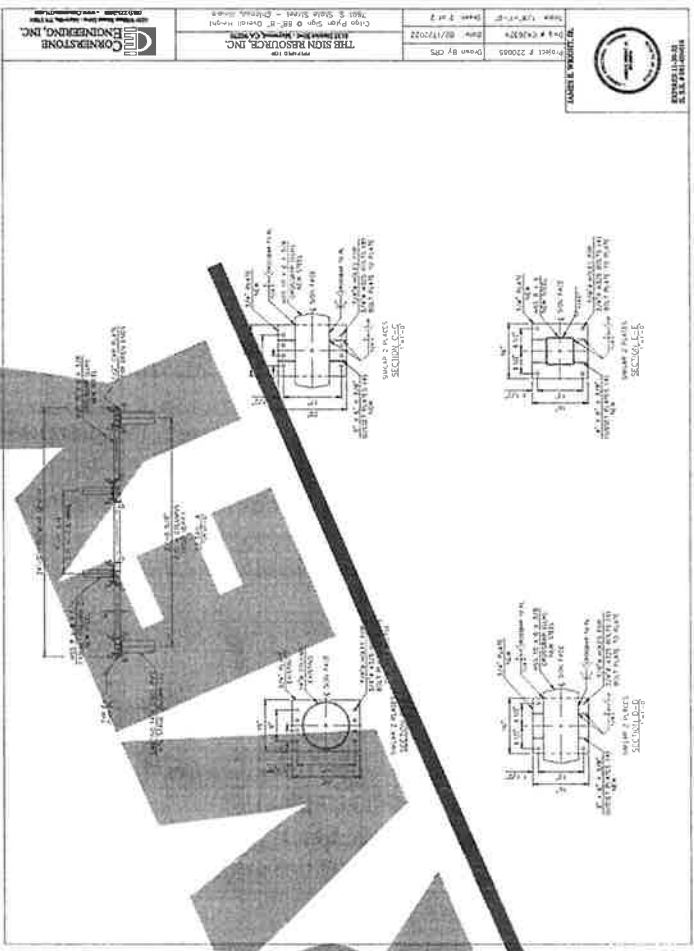

GENERAL NOTES:
 1. THE SIGN SHALL BE FABRICATED AND INSTALLED IN ACCORDANCE WITH THE SIGN MANUFACTURER'S RECOMMENDATIONS.
 2. THE SIGN SHALL BE FABRICATED AND INSTALLED IN ACCORDANCE WITH THE SIGN MANUFACTURER'S RECOMMENDATIONS.
 3. THE SIGN SHALL BE FABRICATED AND INSTALLED IN ACCORDANCE WITH THE SIGN MANUFACTURER'S RECOMMENDATIONS.
 4. THE SIGN SHALL BE FABRICATED AND INSTALLED IN ACCORDANCE WITH THE SIGN MANUFACTURER'S RECOMMENDATIONS.
 5. THE SIGN SHALL BE FABRICATED AND INSTALLED IN ACCORDANCE WITH THE SIGN MANUFACTURER'S RECOMMENDATIONS.
 6. THE SIGN SHALL BE FABRICATED AND INSTALLED IN ACCORDANCE WITH THE SIGN MANUFACTURER'S RECOMMENDATIONS.
 7. THE SIGN SHALL BE FABRICATED AND INSTALLED IN ACCORDANCE WITH THE SIGN MANUFACTURER'S RECOMMENDATIONS.
 8. THE SIGN SHALL BE FABRICATED AND INSTALLED IN ACCORDANCE WITH THE SIGN MANUFACTURER'S RECOMMENDATIONS.
 9. THE SIGN SHALL BE FABRICATED AND INSTALLED IN ACCORDANCE WITH THE SIGN MANUFACTURER'S RECOMMENDATIONS.
 10. THE SIGN SHALL BE FABRICATED AND INSTALLED IN ACCORDANCE WITH THE SIGN MANUFACTURER'S RECOMMENDATIONS.

THE SIGN RESOURCE, INC.
 1000 S. STATE STREET - CHICAGO, ILL. 60605
 (773) 326-1100
 PROJECT # 220005
 DRAW # 2 OF 2
 DATE 08/17/2022
 DRAWN BY CJS

SECTION 1-1
 SECTION 1-2
 SECTION 1-3
 SECTION 1-4
 SECTION 1-5

SECTION 2-1
 SECTION 2-2
 SECTION 2-3
 SECTION 2-4
 SECTION 2-5

SECTION 3-1
 SECTION 3-2
 SECTION 3-3
 SECTION 3-4
 SECTION 3-5

SECTION 4-1
 SECTION 4-2
 SECTION 4-3
 SECTION 4-4
 SECTION 4-5

SURVEY INFORMATION

